

8NW51

4Ω**LF Drivers - 8.0 Inches**

- 400 W continuous program power capacity
- 51 mm (2 in) copper voice coil
- 70 - 3000 Hz response
- 97 dB sensitivity
- Neodymium ring magnet assembly
- Shorting copper cap for extended HF response
- Ventilated voice coil gap for reduced power compression

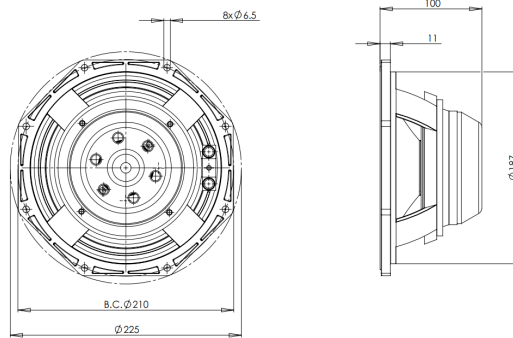

8NW51

LF Drivers- 8.0 Inches

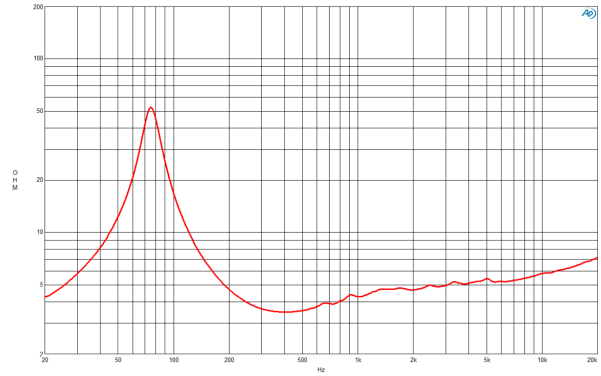
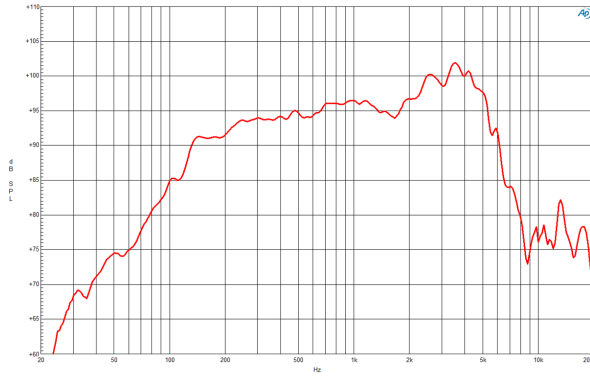

SPECIFICATIONS

| | |
|--|-------------------|
| Nominal Diameter | 200 mm (8.0 in) |
| Nominal Impedance | 4 Ω |
| Minimum Impedance | 3.7 Ω |
| Nominal Power Handling ¹ | 200 W |
| Continuous power handling ² | 400 W |
| Sensitivity (1W/1m) ³ | 97.0 dB |
| Frequency Range | 70 - 3000 Hz |
| Voice Coil Diameter | 51 mm (2.0 in) |
| Winding Material | Copper |
| Former Material | Glass Fibre |
| Winding Depth | 16.0 mm (0.65 in) |
| Magnetic Gap Depth | 10.0 mm (0.4 in) |
| Flux Density | 1.3 T |

DESIGN

| | |
|-----------------------|---------------------------|
| Surround Shape | Double Roll |
| Cone Shape | Exponential |
| Magnet Material | Neodymium Ring |
| Spider | Single |
| Pole Design | T-Pole |
| Woofer Cone Treatment | TWP Waterproof Both Sides |

PARAMETERS⁴

| | |
|---------------------|---|
| Resonance Frequency | 76 Hz |
| Re | 2.5 Ω |
| Qes | 0.26 |
| Qms | 5.3 |
| Qts | 0.25 |
| Vas | 10.6 dm ³ (0.37 ft ³) |
| Sd | 220.0 cm ² (34.1 in ²) |
| η _o | 1.76 % |
| X _{max} | ± 6.0 mm |
| X _{var} | ± 5.0 mm |
| M _{ms} | 27.0 g |
| Bl | 11.2 Txm |
| Le | 0.2 mH |
| EBP | 292 Hz |

MOUNTING AND SHIPPING INFO

| | |
|-------------------------------|---|
| Overall Diameter | 225 mm (8.8 in) |
| Bolt Circle Diameter | 210 mm (8.3 in) |
| Baffle Cutout Diameter | 187.0 mm (7.4 in) |
| Depth | 100 mm (4.0 in) |
| Flange and Gasket Thickness | 11 mm (0.4 in) |
| Air Volume Occupied by Driver | 1.1 dm ³ (0.04 ft ³) |
| Net Weight | 3.05 kg (6.72 lb) |
| Shipping Units | 1 |
| Shipping Weight | 3.5 kg (7.72 lb) |
| Shipping Box | 255x255x150 mm (10.04x10.04x5.91 in) |

SERVICE KIT

| | |
|------------|-------------|
| Recone kit | RCK008NW514 |
|------------|-------------|

1. 2 hours test made with continuous pink noise signal within the range Fs-10Fs. Power calculated on rated minimum impedance. Loudspeaker in free air.
2. Power on Continuous Program is defined as 3 dB greater than the Nominal rating.
3. Applied RMS Voltage is set to 2V for 4 ohm Nominal Impedance
4. Thiele-Small parameters are measured after a high level 20 Hz sine wave preconditioning test.